

User manual for ELLIX30/40 Kitchen bell

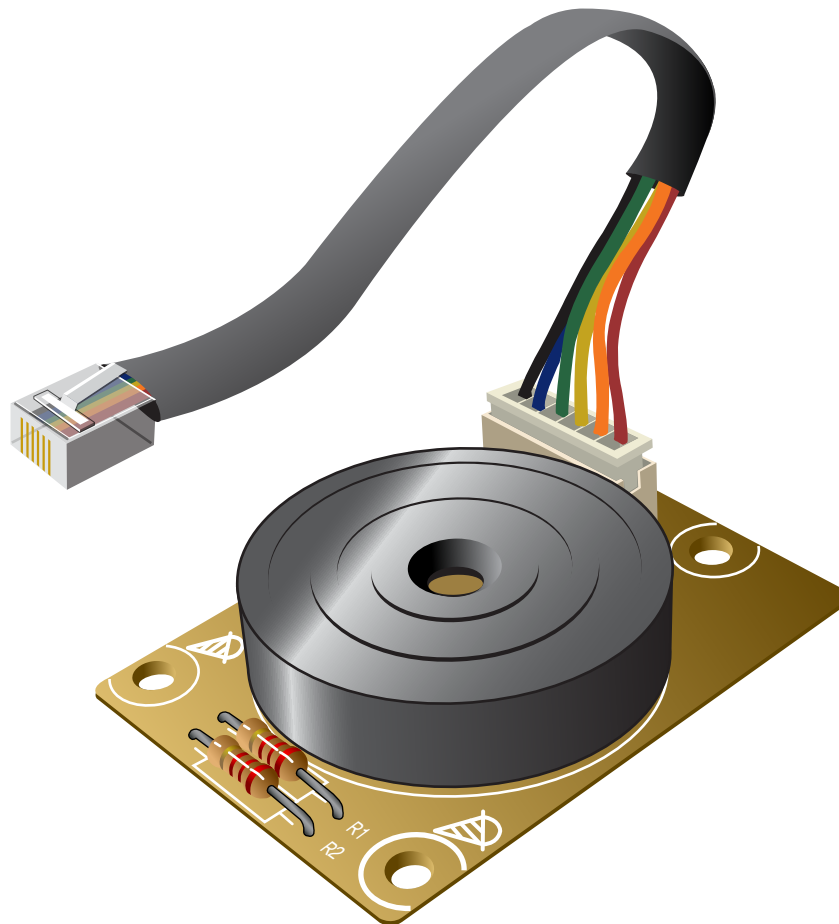

SAM4S

01. Kitchen-Bell Installation

UNPACKING

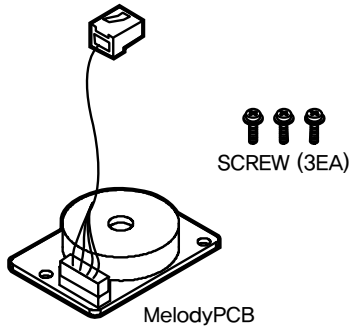

CAUTION

- ▶ Before installation, be sure to turn off the power switch.
- ▶ Use gloves to protect your hand from being cut by the angle and the chassis.

Figure 20

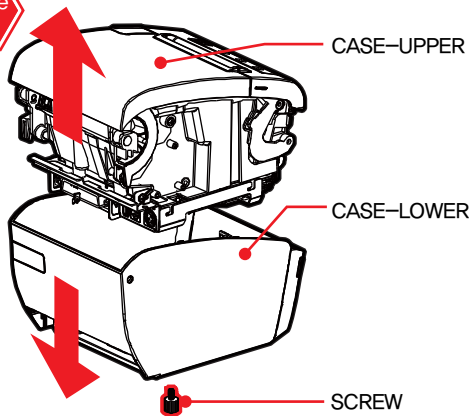

1. Remove the screw and separate the CASE-UPPER from the CASE-LOWER.(fig.20)

Figure 21

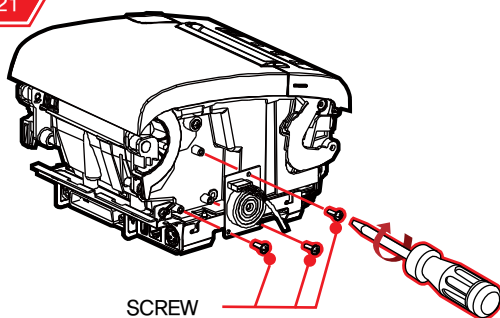

2. Take the enclosed Melody PCB and fix the screws (3EA) as shown.(fig.21)

Figure 22

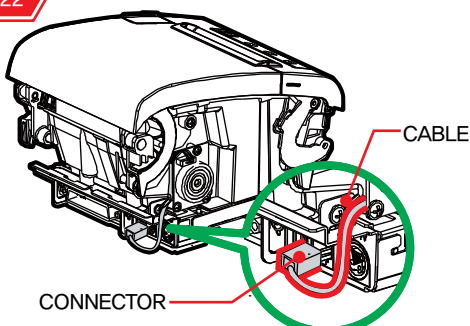

3. Fix the Melody PCB cable as shown.(fig.22)
Then Insert the connector to the Main PCB and reassemble the CASE-UPPER, CASE-LOWER.

02. How to set up a kitchen ELLIX30/40 Bell

Turn off the printer and install the kitchen bell. And DIP switch of ELLIX30/40 of should be set as shown below. (DIP switch is located on the bottom of the printer.)

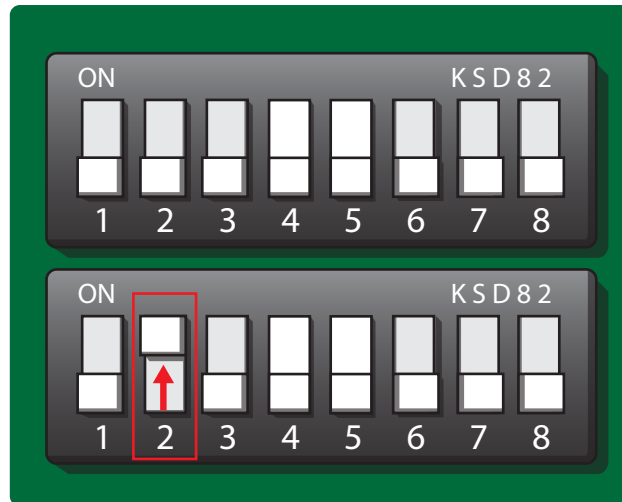

If you have a LCD display of ELLIX40, please set the kitchen bell open-minded the printer as follows.

- ① Press a 2nd button(MENU) from “Ready” screen during 1 second



- ② Press a 3rd button(NEXT) from “Interface” screen to find a “Generic” item

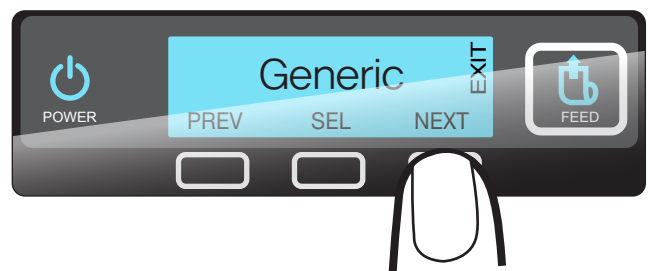
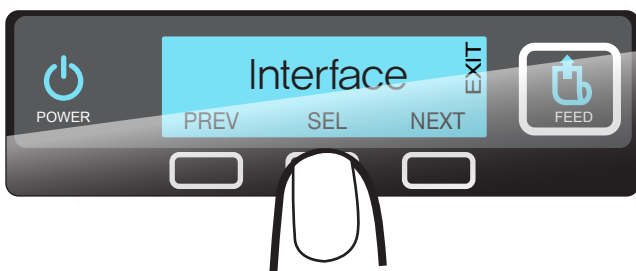

- ③ Press a 2nd button (MENU) from “Generic” screen

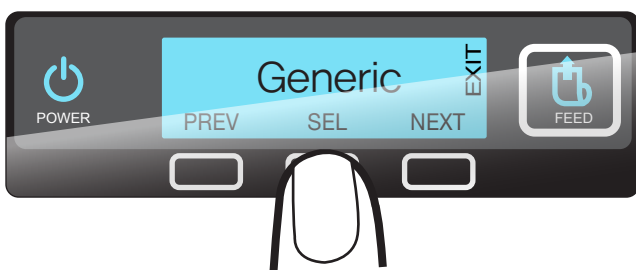

02. How to set up a kitchen ELLIX30/40 Bell

- ④ Press a 3rd button (NEXT) to find a Kitchen Bell” item and then press 2nd button to select the item



- ⑤ Press a 3rd button (NEXT) to find a “Enable” item. And then press 2nd button to select a item.

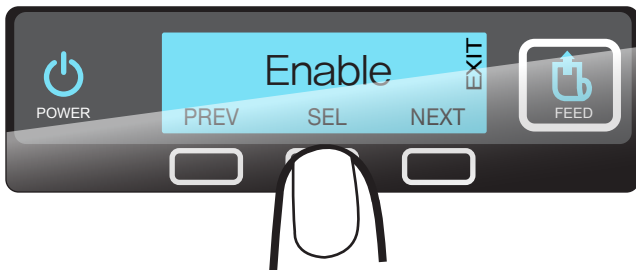

- ⑥ Press a FEED button to find a “SAVE?” item

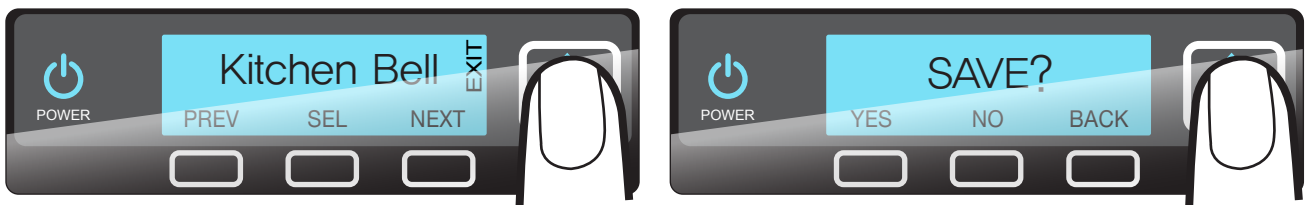

- ⑦ Press a 1st button (YES) to save setting values

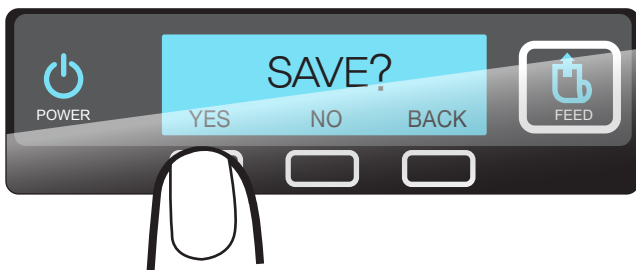

ELLIX30/40 will play a kitchen bell when printer cut a paper(GS V m command)

02. How to set up a kitchen ELLIX30/40 Bell

ELLIX30/40 supports default sound and 3 melodies.

If you want to change other melody, please use the ELLIXSet utility.

(Download link : <http://www.sam4s.com/bbs/viewbody.asp?code=util&page=1&id=23&number=23&keyfield=&keyword=&category=&BoardType=&admin=>)

- ① Run ELLIXSet Utility.
- ② Select a DEVICE(target printer) and PORT from a main dialog.
- ③ Select a USER setup dialog.
- ④ Select a melody type and length (repeat count) from “kitchen Bell Type & Length”.

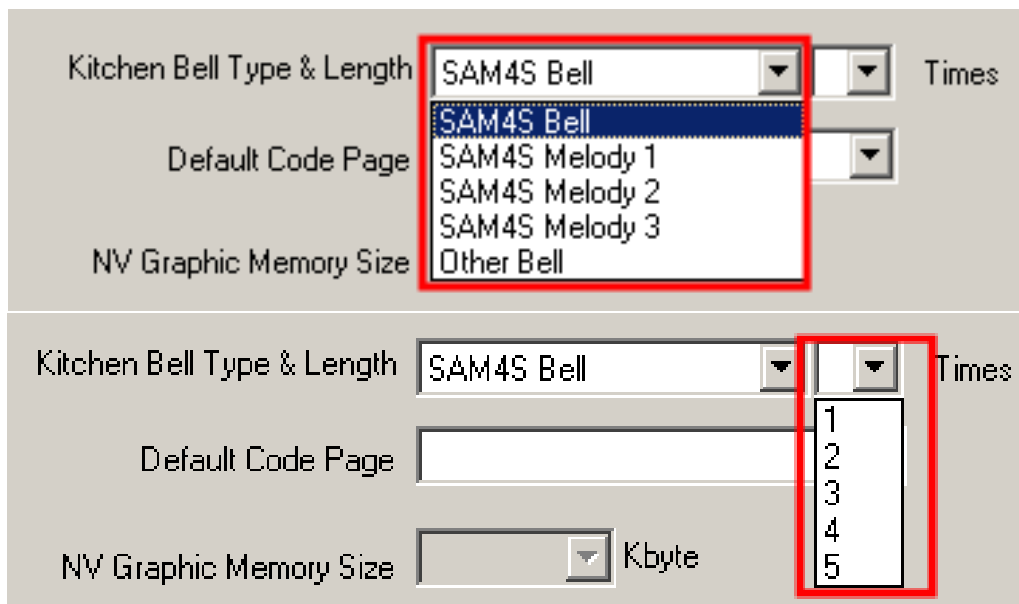

- ⑤ Press a “Set Value” button for save setting values.



- ⑥ Press a “TEST” button and then check a melody sound.